



ART

WALK



May - August 2024

First Fridays < 6pm-8pm

IN THE PARK

- > Exhibitions & Sales
- > Open Studios
- > Art Demonstrations

Friday, June 7, 2024, 6-8 pm

LOCATION

Art Glass Center at Glen Echo	Open Studio, Art Sales		3 Art Glass Center at Glen Echo
Glen Echo Glassworks	Open Studio, Art Sales, Glassblowing Demo	Studio Sale, 5-8 pm	10 Caretaker's Cottage
Glen Echo Pottery	Open Studio, Art Sales, <i>Featured Artist: Eunkyung Han</i>		13 Pottery Gallery Yurt
Park View Gallery	Exhibition - <i>Photoworks Student Photography Exhibition: Summer School</i>	Opening Reception, 6-8 pm	17 Park View Gallery 2nd Flr Arcade Building
Photoworks	Open Studio, Art Sales Exhibition - <i>Good Sports juried exhibition</i>		18 Photoworks Studio 1st Flr Arcade Building
Popcorn Gallery	Exhibition - <i>Art Glass Center at Glen Echo: Glass: Visions and Voices 2024</i>	Opening Reception, 6-8 pm	21 Popcorn Gallery 1st Flr Arcade Building
Public Art Installation	<i>Lauri Hafvenstein, Magic Staircase</i>	Opening Reception, 6-8 pm	Arcade Building Staircase 2nd & 3rd Floors
Sculpture Studio	Open Studio		26 Sculpture Studio Yurt
SilverWorks Studio & Gallery (Studio 1 & 2)	Open Studio, Art Sales		24 SilverWorks Studio 1 2nd Floor Yellow Barn 25 SilverWorks Studio 2 Bldg (Rear)
Stone Tower Gallery	Exhibition - <i>Melanie Kehoss: Tales, Near and Far</i>	Opening Reception, 6-8 pm	28 Stone Tower Gallery 1st Flr Chautauqua Tower
Stone Tower Studio	Open Studio, Live Painting, Art Sales		29 Chautauqua Tower 2nd & 3rd Floors
Yellow Barn Studio	Jennifer Hughes, Oil and Cold Wax Painting Demo		Outdoors, near Yellow Barn Studio

SEE REVERSE FOR PARK MAP

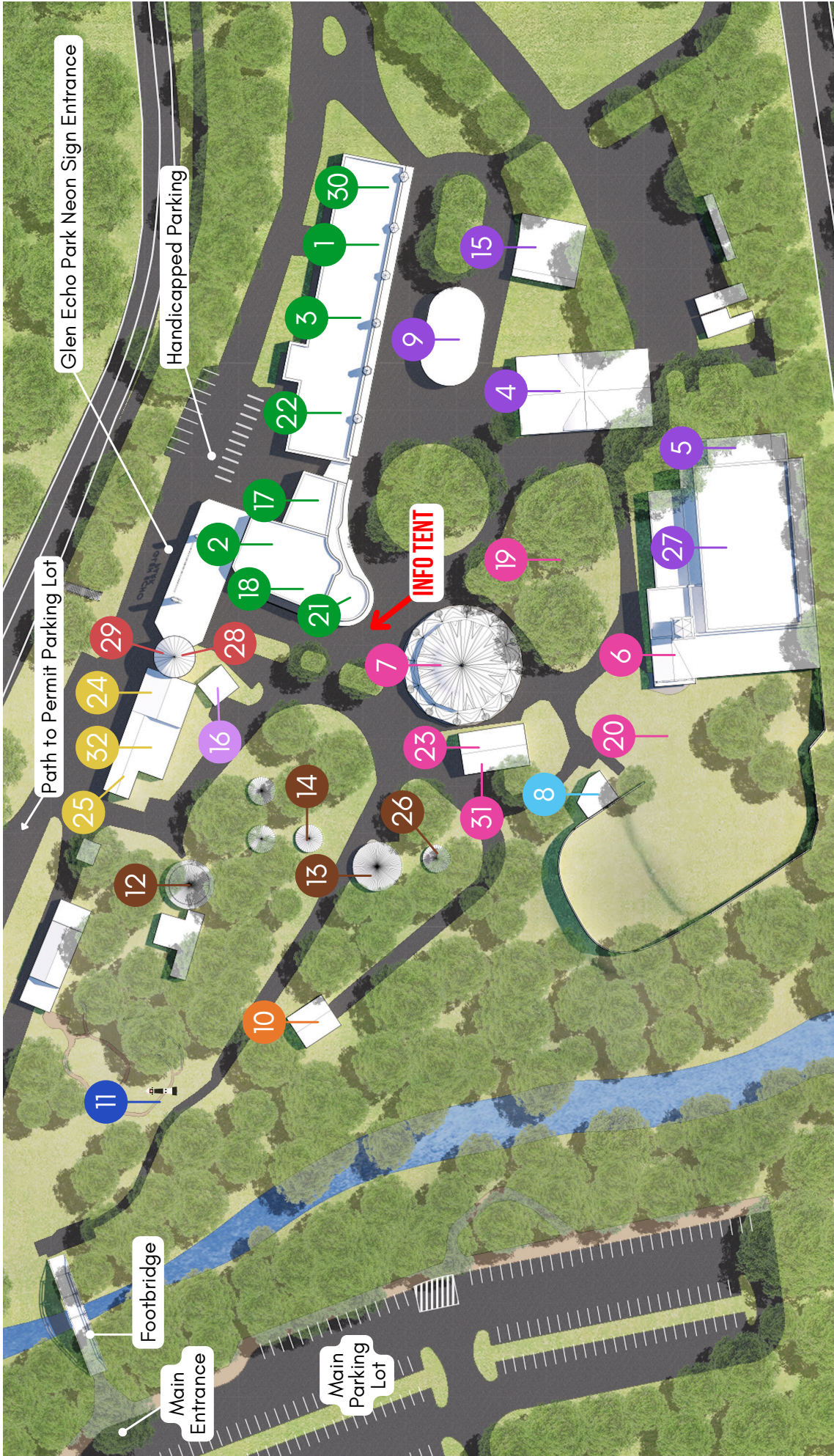

- ARCADE BUILDING
- DANCE & EVENT VENUES
- YELLOW BARN BUILDING
- AMENITIES & CAROUSEL
- YURTS
- CRYSTAL POOL STUDIO
- CHAUTAUQUA TOWER
- CANDY CORNER
- GLASSBLOWING STUDIO
- GLEN ECHO PARK AQUARIUM

- 1. ADVENTURE THEATRE MTC
- 2. ARCADE CLASSROOMS (2nd Floor; incl. WCM extra classrooms)
- 3. ART GLASS CENTER AT GLEN ECHO
- 4. BUMPER CAR PAVILION
- 5. BALLROOM BACK ROOM
- 6. CAFE/PRAIRIE AT GLEN ECHO PARK
- 7. CAROUSEL
- 8. CHILDREN'S ART CLASSES
- 9. CUDDLE UP PAVILION
- 10. GLEN ECHO GLASSWORKS
- 11. GLEN ECHO PARK AQUARIUM ENTRANCE
- 12. GLEN ECHO POTTERY (WHEEL YURT)
- 13. GLEN ECHO POTTERY GALLERY/HANDBUILDING YURT
- 14. GLEN ECHO POTTERY (SMALL HANDBUILDING YURT)
- 15. HALL OF MIRRORS DANCE STUDIO
- 16. NATIONAL PARK SERVICE (NPS) PROGRAMMING
- 17. PARTNERSHIP OFFICE/PARK VIEW GALLERY (2nd Floor)
- 18. PHOTOWORKS
- 19. PICNIC AREA
- 20. PLAYGROUND
- 21. POPCORN GALLERY
- 22. THE PUPPET CO.
- 23. RESTROOMS
- 24. SILVERWORKS STUDIO 1
- 25. SILVERWORKS STUDIO 2
- 26. SCULPTURE STUDIO
- 27. SPANISH BALLROOM
- 28. STONE TOWER GALLERY
- 29. STONE TOWER STUDIO
- 30. WASHINGTON CONSERVATORY OF MUSIC (WCM)
- 31. WASHINGTON REVELS OFFICE
- 32. YELLOW BARN STUDIO & GALLERY



The Glen Echo Park Partnership for Arts and Culture is supported in part by the Maryland State Arts Council (fmsac.org) and also by funding from the Montgomery County government and the Arts & Humanities Council of Montgomery County (enartsmontgomery.com). All programs are produced in cooperation with the National Park Service and Montgomery County, Maryland.